



# AQUARIUM 500R OWNER'S MANUAL



**Add Life to Art™**

*Please read the owner's manual before installing and setting up your  
aquarium unit*

# Table of Contents

Chapter 1	Important Safety Instructions-----	3
Chapter 2	Parts Diagram and components-----	4
Chapter 3	Installation Guide-----	6
	Unpacking the unit	
	Securing the unit to studs in the wall	
	Setting up filtration (rinse gravel and filtration media)	
	Hanging the unit	
	Attaching a picture frame	
	Turn on the aquarium	
Chapter 4	User Instructions-----	11
	Programmable LCD control panel introduction	
	Factory Settings	
	Mode Settings	
	Manual Control	
	Special Introduction	
Chapter 5	Maintenance-----	15
	Maintenance and care	
	Troubleshooting	
	Change lamp, picture frame, background picture	

## Chapter 1 Important Safety Instructions

*Please read the owner's manual before installing and setting up your aquarium unit.*

Warning--To guard against injury, basic safety precautions must be observed, including but not limited to following. **READ AND FOLLOW ALL SAFETY INSTRUCTIONS.** To avoid possible electric shock, special care should be taken in the use of aquarium equipment.

Do not attempt to set up nor use the tank without reading this manual first. If you have any questions or repair, please contact your local authorized dealer or our company.

1. If the appliance shows any sign of abnormal water leakage, immediately unplug from the power source.
2. Carefully examine the appliance after installation. It should not be plugged in if there is water on parts not intended to be wet.
3. Do not operate any appliance if it has a damaged cord or plug, or if it is malfunctioning or if it is dropped or damaged in any manner.
4. To avoid the possibility of the appliance plug or receptacle getting wet, position aquarium stand and tank to one side of a wall mounted receptacle to prevent water from dripping onto the receptacle or plug. A "drip loop" should be arranged by the user for each cord connecting an aquarium appliance to a receptacle. If the plug or receptacle does get wet, **DO NOT** unplug the cord. Disconnect the fuse or circuit breaker that supplies power to the appliance. Then unplug and examine for presence of water in the receptacle.
5. Close supervision is necessary when any appliance is used by or near children.
6. Make sure the tank is securely mounted onto the wall before operating it.
7. Do not connect the unit to any power until the product is completely installed in order to avoid causing any damage to its parts as well as preventing human body from injury.
8. Do not turn on the power switch if the product contains no water or the water level is below the minimum water level line (MIN).
9. Always unplug the product before performing maintenance and cleaning.
10. Always unplug an appliance from an outlet when not in use, before putting on or taking off parts, and before cleaning. Never yank cord to pull plug from outlet. Grasp the plug and pull to disconnect.
11. Make sure that at least two holes of steel mounting bracket is secured to wood, metal or cement studs in the wall. If unsure of the construction of the wall or building, please check with the appropriate parties.

12. Never hang or remove the tank when full of water. It is recommended to fill up the aquarium with water after the aquarium has been securely hung onto the steel mounting bracket in order to avoid personal body injury.
13. Do not use an appliance for other than intended use. The use of the product should be in compliance with the electrical voltage as indicated by the plate. Please consult authorized dealer or the local electricity company if you are not certain.
14. If an extension cord is necessary, a cord with a proper rating should be used. A cord rated for less amperes or watts than the appliance rating may overheat. Care should be taken to arrange the cord so that it will not be tripped over or pulled.
15. If there is any problem with the unit, do not attempt repairs yourself, please contact the authorized dealer or our company. Repairing it yourself may cause potential bodily injury or harm. The Company will not be liable for such responsibility.
16. Any unauthorized repairs or modifications will void any warranty and release the manufacturer and distributor of all liability or any damages caused by the product.

## Chapter 2 Parts Diagram and Components

### 1. Product Components

The product includes a decorative picture frame, an aquarium unit, steel mounting bracket and accessories. Screws and anchors aren't included.

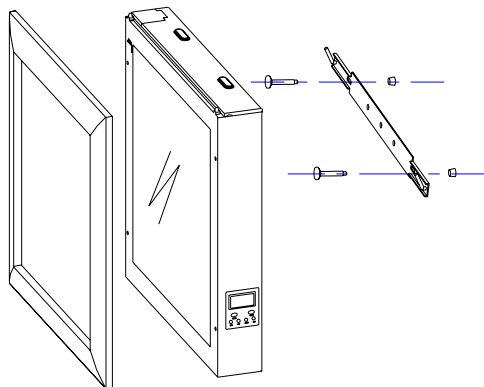

## 2. Structure of the Aquarium Tank

### Parts Diagram & Identification

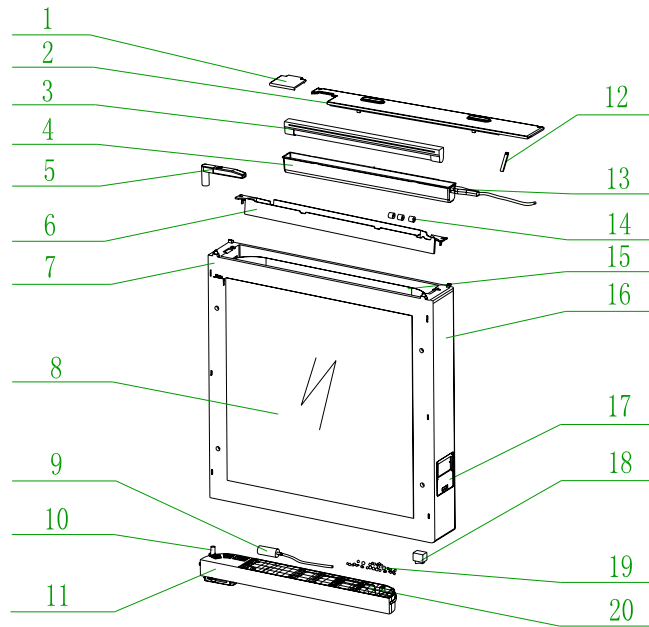

- |                         |                                    |
|-------------------------|------------------------------------|
| 1. Feeding hatch        | 11. Aluminum mesh                  |
| 2. Aquarium cover       | 12. Small pillar                   |
| 3. Aquarium lamp        | 13. Power wire of lamp             |
| 4. Lampshade            | 14. Porcelain bio balls            |
| 5. Flow diverter        | 15. Background picture             |
| 6. Drip tray and filter | 16. Air pump                       |
| 7. Tank body            | 17. Programmable LCD control panel |
| 8. Acrylic screen       | 18. Power switch                   |
| 9. Bubble stone         | 19. Gravel                         |
| 10. Water pump          | 20. Heater                         |

## Chapter 3 Installation Guide

Before you begin installation, unpack and inspect all parts. Check to make sure you have all that are listed on the packing list. If any are missing or damaged, there is no need to return the entire Aquarium unit. Replacement parts may be obtained from the store where purchased, or by calling us or the local distributor.

### STEP 1: Unpacking the Unit

1. Remove packing tape from top of unit.
2. Disconnect Flow Diverter and remove Drip Tray. Flow Diverter can be removed by separating the flow diverter from the elbow by gently pushing the arrows on the flow diverter and outflow elbow in opposite directions. Drip tray can be removed by gently shifting it toward the left and lifting Drip Tray on right side until the Drip Tray unlocks.
3. Remove plastic bag and Styrofoam insert.

### STEP 2: Securing the Steel Bracket to Studs in the Wall

Note: Make sure the steel mounting bracket is securely installed before mounting the aquarium onto the wall. The steel mounting bracket should be secured into the studs of the wall using screws.

1. Find wood, steel or cement studs using stud finder.
2. Align the two main holes (diameter 8mm, depth 60mm, between centre 16in/406mm) to the studs on the wall in the same horizontal line and use screws to fix the steel mounting bracket to the wall. It is recommended to use a leveler to make sure the steel bracket is mounted evenly.

\*Note: For more secure hanging, there are three additional holes in the steel mounting bracket that can be used to secure the tank. At the very minimum, two holes must be used, if secured by studs.

\*Note: The total weight of the tank is approximately 37.5kg (80 lbs) when it is full with water.

3. Use the screws to fix the steel mounting bracket on the wall.



### STEP 3: Setting up Filtration (Rinse Gravel and Filtration Media)

1. Remove gravel and porcelain bio balls from package. (see picture below)



Accessories

2. Rinse gravel and porcelain bio balls with cold or lukewarm water to remove any dust and small particles.

\*Note: Not all of the porcelain bio balls need to be used. Use enough porcelain bio balls to cover the drip tray with one layer of bio balls.

### STEP 4: Hanging the unit

1. There are two specially molded holes on the back of the aquarium tank for hanging the unit onto the two steel hooks of the steel mounting bracket. Align the two holes with the hooks and slide the unit down. If mounted properly, the aquarium should lay flush against the wall.

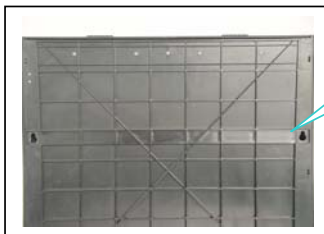

Two hanging holes on the back of the aquarium tank

2. Open the top cover, using the right corner small pillar to support it.

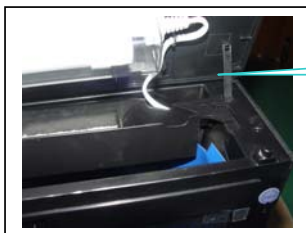

Small pillar

3. Fill tank with water up to the minimum water level line (MIN).

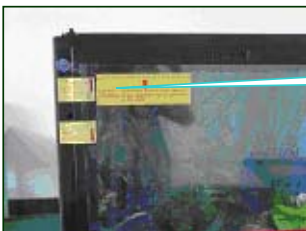

MIN water level line

4. Pour gravel, distribute it evenly along the bottom of the tank. Insert the filter sponge into the drip tray and attach drip tray into unit.

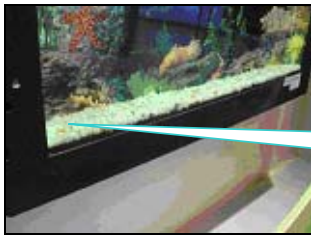

Gravel

5. Connect the flow diverter; make sure the flow diverter is securely connected.



Flow diverter

6. Lay porcelain bio balls onto the filter sponge.  
\*Note: One layer should be enough



Porcelain bio balls



Filter

7. Make sure the aquarium lamp is snugly connected.



Aquarium lamp

8. Fill water until it reaches the maximum water level line (MAX). The tank can fit 6.6 gallons of water.

\*Note: Do not fill water beyond the MAX water level line. If filled above the MAX level, unit's overflow will cause water to drip from side of tank until back to appropriate level.



MAX water level line

9. Remove the clear protection film from the aquarium tank surface.



10. Turn down the small pillar and close the top cover.

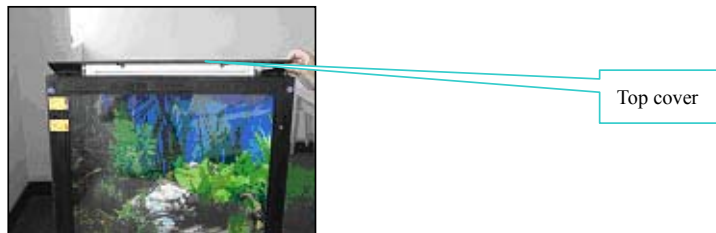

#### STEP 5: Attaching a Picture Frame

1. **To Install Modern picture frame:** Align the four pins of the modern picture frame with four holes of the aquarium tank and gently press to snap the frame to the aquarium unit. Make sure that pressure is applied evenly.



2. **To install the Classical picture frame:** Hang the Classic picture frame onto the two molded pins at the top of the aquarium tank, matching the two indentations on the inside of the frame. Gently press the bottom of the frame until the buckles at the bottom snap to the unit.

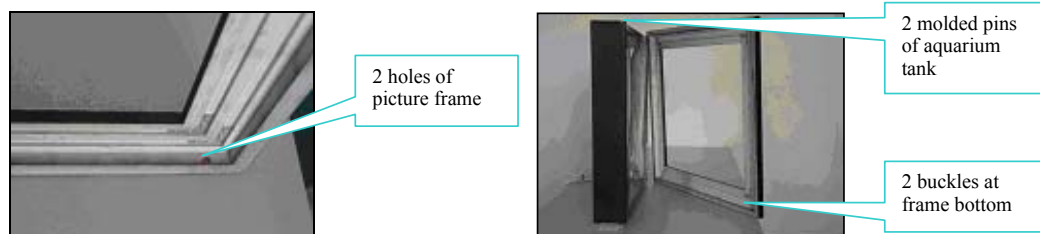

#### STEP 6: Turn on the Aquarium

1. Connect aquarium plug to the power source and turn on the power switch, which is located underneath the right side of the unit.

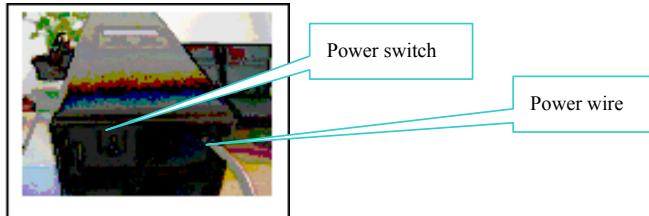

2. The aquarium tank will work under the default setting mode and cycle the water.  
\*Note: Fish can be put into the tank after the aquarium tank has been working 24 hours.



**Important Note: When setting up a new aquarium, it is important to build up the beneficial bacteria culture to develop a healthy tank environment and develop peak operational efficiency. Begin with a couple fish to stimulate bacteria growth. Add more fish gradually after a 4-6 weeks period. Tank bacteria can be accelerated by adding water from an established aquarium environment to speed the break-in process.**

**There is no need to replace the porcelain bio balls unless they are damaged or there are not enough. Porcelain bio balls should never be rinsed nor cleaned in any tap or distilled water. If bio balls need to be cleaned, gently rinse in water from aquarium to preserve the bacteria that has grown in the pores of the porcelain bio balls. Filters should be replaced or cleaned periodically with water changes.**

## Chapter 4 User Instruction

### 1. Programmable LCD Control Panel Introduction

Functions of the panel & names of the keys

1. Time display
2. Filter cycling status display
3. Air pump status display
4. Heating status display
5. Lighting status display
6. Filter cycling mode display
7. Water temperature display
8. Time setting key
9. Lighting control key
10. Mode selection key
11. Filter cycling control key
12. Air pump control key
13. Setting key

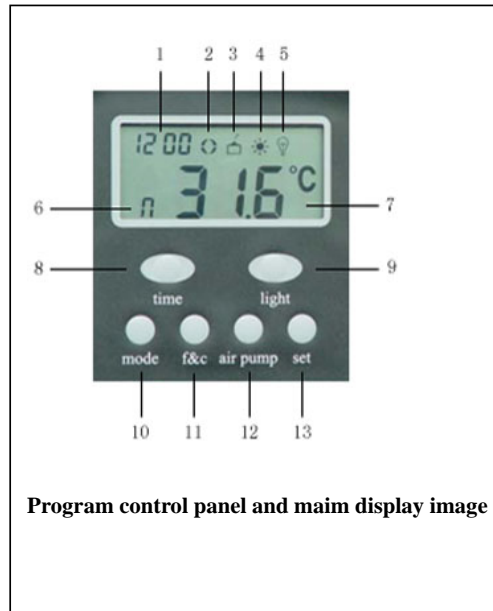

Program control panel and main display image

### 2. Factory Settings (Default Settings)

The Aquarium 500R default settings are appropriate for most aquarium environments.

#### Default settings

1. Clock: The initial time is 12:00 when switching on the machine.
2. Filter cycling: Before you carry on any setting, the filter cycling is operated in enforced mode 'E' (see below for details).
3. Air pump: The system is preset to provide with 3 minutes of oxygen providing time in one hour from 6:00 to 22:00. It stops working from 22:00 to 6:00.
4. Temperature: The default value is 25 °C./ 77 Fahrenheit
5. Lighting: The aquarium is preset to be on for one half-hour default lighting time (12:00—12:30) every day.

### 3. Mode settings

The unit can be manually programmed to modify the operating state of the aquarium tank's settings.

#### To set the time clock

1. Press the **【time】** key under the main display image, the minute display will start flashing.  
Press the **【set】** key, and set minutes.
2. Press again **【time】** key, the hour display of the clock will start flashing.
3. Press the **【set】** key to set the hour.
4. Press again **【time】** key again to save settings, upon which the time display stops flashing while saving your setting.

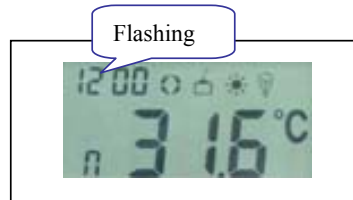
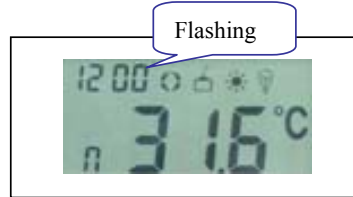

\*Note: The clock will automatically revert to normal setting if no buttons on the panel are pushed for 20 seconds.

#### Filter cycling mode settings

There are three (3) types of preset filter cycling modes that can be selected, i.e. normal mode, enforced mode and cycle mode.

mode	Filter cycling minutes per time	period
Normal mode (display 'N')	Cycling 45', stop15'	0:00-24:00
Enforced mode (display 'E')	Cycling 105', stop15'	0:00-24:00
Cycle mode (display 'C')	Cycling 105', stop15'	6:00-22:00
	Cycling 15', stop105'	22:00-6:00

1. Press **【mode】** key 3 times and enter the filter cycling mode setting (see image on the right).  
There are three settings available: "N", "E" or "C".
2. Press **【set】** key to select the setting you want.
3. Press **【mode】** key twice to return to the main display image.

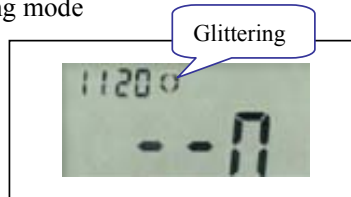

### Setting the temperature

The product's heater can be set to different temperatures, depending on the preferred habitats of different fishes. The setting range is from 6 °C to 32°C /42.8°F to 89.6°F.

\*Note: The main display image displays the actual water temperature; when the environmental temperature exceeds the setting value, the heater will automatically shut off until the temperature of the aquarium falls below the setting value.

1. Press **【mode】** key 4 times under the main display image, and then enter the temperature setting (See image on right)
2. Press **【set】** key to adjust to the temperature value you want.
3. Press **【mode】** key one more time to save settings and return to main display image.

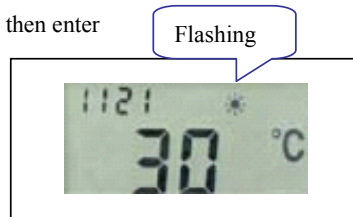

### To view temperature in either °C and °F

The temperature can be displayed in either °C and °F. To change the temperature setting:

1. Press **【mode】** key 4 times under you see the temperature on the screen.
2. Press **【air pump】** key to switch the view between °C and °F.
3. Press **【mode】** key once to return to the main display image.

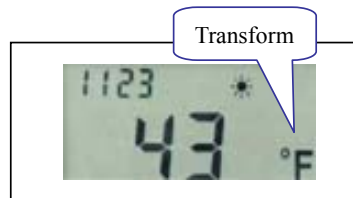

### To program the light with automatic timer

For the convenience of the users, the unit comes with an embedded automatic timer that can be programmed to switch the light on and off.

1. Press the **【mode】** key under the main display image, confirm that the image is the same as that on the right.
2. Press **【set】** key to adjust the minute value of the time you want.
3. Press again **【time】** key, confirm that the hour of the clock starts flashing.
4. Press **【set】** key to adjust the hour value of the time you want.
5. After set up the light switch and time, press the **【mode】** key in order to enter the automatic light switch off setting, as displayed to the image on the right.
6. The light switch timer off setting is programmed the same as the light switch “on” setting.
7. Press **【mode】** key 3 times and return to the main display image.

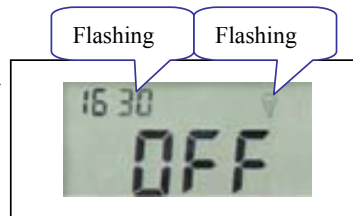
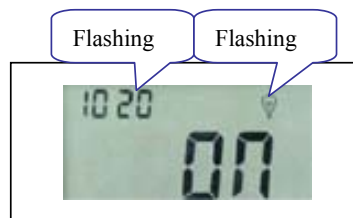

#### 4. Manual Control

The filter cycling, air pump and lighting of the product can be programmed to turn on and off manually.

##### Filter cycling manual control

Press the **【filter cycling】** key under the main display image to manually switch the filter on and off. If the manual controls are not resolved, it will keep the state until it automatically works according to the setting.

##### Air pump manual control

Press the **【air pump】** key under the main display image to manually control the air pump.

1. When the air pump stops, press **【air pump】** key to start the air pump. If there is no more manual operation, it will keep the state until the 4<sup>th</sup> minute of the next hour, and then works automatically according to the setting. If the air pump is manually started from 22:00 to 6:00, it will stop working at 6:04, it works automatically according to the setting.
2. When the air pump is on, if you press **【air pump】** key, the air pump stops. If there is no more manual operation, it will keep the state until the next full o'clock time, and then it works automatically according to the setting.
3. The air pump can stop working for a long period of time. Press **【air pump】** key under the main display image about 6 seconds to convert the default state to pure manual state. If you made the default state comeback, press **【air pump】** key again for 6 seconds to convert the pure manual state to default state.

Under the default state:

When the air pump is working, the air pump signal is slowly flashing.

When the air pump stops working the air pump signal will still not flash.

Under pure manual state:

When the air pump is working, the air pump signal is flashing.

When the air pump stops working the air pump signal is invisible.

##### Lighting manual control

Press the **【light】** key under the main display image to manually control the light switch on and off. If there is no more manual control, it will keep the state until it automatically works according to the setting.

#### 5. Special Introduction

1. When the water temperature is over 32°C, the main image will display the warning signal, as displayed in the image to the right, which suggests that the temperature of the aquarium tank is too hot.
2. Under the mode setting state, if the user does not program or carry out any operation within 20 seconds, it will return to the main display image.
3. Under the main display image, press **【set】** key about 6 seconds till the display image is full of symbols to restore the factory settings.
4. To ensure its proper use and free from being disturbed, the electric socket supplying power should be placed nearby the product and is recommended to be used alone or with a surge protector.

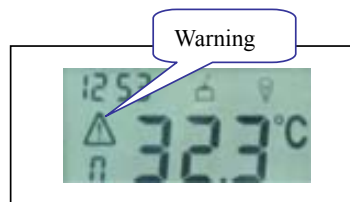

## Chapter 5 Maintenance

Proper system maintenance begins with frequent visual inspections to ensure normal system operation

and non-stressful conditions for fish. The Aquarium 500R's hinged cover makes it easy to inspect the filtration system, change the filter. Or change the lamp without removing the entire unit. Feeding and daily visual monitoring may be done through the top.

Basic aquarium maintenance includes regular 25% water changes (every 2-4 weeks) and gravel cleaning, as well as regular filter sponge cleaning.

### 1. Maintenance

- 1.1 The aquarium tank is suitable for keeping small or medium-sized fishes.
- 1.2 Please put fish into the tank after switching on the power supply for 48 hours.
- 1.3 It is advised to do a partial water change periodically. It is also recommended to clean or replace the filter sponge every four to six weeks.
- 1.4 After the first four week cycle, it is advised to put an algae eating type of fish in the aquarium such as a plecostamus or Chinese Algae Eater to keep the aquarium tank cleaner.
- 1.5 Put some active carbons on the porcelain bio balls to improve water quality.
- 1.6 Avoid setting up the aquarium in any area where it will receive direct sunlight to avoid extraneous algae growth.
- 1.7 No chemicals or detergents should ever be used to clean the tank.
- 1.8 Tools for special use and soft cleaning cloth should be utilized for cleaning the internal parts and the transparent panel of the aquarium tank. Take special care to avoid scratching the background picture and transparent panel for it may affect its aesthetic beauty and transparency.
- 1.9 Avoid overfeeding the fish.
- 1.10 Additional supplies can be purchased through Aquavista or at your local pet store.

## 2. Troubleshooting

Problem	Cause	Solution
Light is not functioning	<ul style="list-style-type: none"> <li>■ The aquarium lamp connection is loose.</li> <li>■ The light bulb needs to be replaced.</li> </ul>	<ul style="list-style-type: none"> <li>■ Check lamp connection and reconnect lamp snugly.</li> <li>■ Inspect the light tube for burnout. To replace light tube, turn off power and unplug aquarium plug to change the lamp.</li> </ul>
No recycling water	<ul style="list-style-type: none"> <li>■ The water pump is blocked by air and the impeller rotates but water does not flow out of the water pipe.</li> <li>■ Water pipe is blocked.</li> </ul>	<ul style="list-style-type: none"> <li>■ Lightly tap the left down corner of the aquarium tank to push out the air.</li> <li>■ Use the pipe cleaner to clean up the water pipe.</li> </ul>
Air pump does not work properly	<ul style="list-style-type: none"> <li>■ Gravel may be blocking the bubble stone at the bottom of the tank.</li> <li>■ Air pump turns on and off intermittently.</li> </ul>	<ul style="list-style-type: none"> <li>■ Make sure gravel is spread evenly on bottom.</li> <li>■ The air pump in the unit is preset to turn on and off intermittently. See instructions to switch to manual control or different setting.</li> </ul>
The unit does not turn on	<ul style="list-style-type: none"> <li>■ The power plug is not plugged into the wall properly.</li> <li>■ The power switch is turned off.</li> </ul>	<ul style="list-style-type: none"> <li>■ Connect the power plug snugly into power source</li> <li>■ Turn the power switch on.</li> </ul>

## Other Troubleshooting

Please Immediately Contact the Authorized Dealer or Our Company

### 3. Change aquarium lamp, picture frame and background picture

#### 3.1 Change aquarium lamp

- 3.1.1 Turn off the power switch, open the top cover and unplug for the lighting.
- 3.1.2 Remove 4 screws the back of the top cover.
- 3.1.3 Remove the lamp shade and plastic pads on each end of the lamp tube, rotate the lamp tube 90 degree and pull it out.
- 3.1.4 Replace a discarded lamp tube with a new lamp tube.
- 3.1.5 Plug for the lighting and turn on the power switch.
- 3.1.6 Readjust the time setting.

#### 3.2 Change picture frame

- Modern picture frame
  - 3.2.1 Separate the upper part of the picture frame by carefully pulling out the upper part of the frame using both hands.
  - 3.2.2 Repeat the actions for the lower part of the picture frame and get it down.
  - 3.2.3 Install the four pins of the new picture frame into the four holes of the aquarium tank.
- Classic picture frame
  - 3.2.4 Pull out the lower part of the picture frame and separate it from the aquarium

tank.

3.2.5 Gently push the frame upward to lift the picture frame off from the tank.

3.2.6 Match the two holes of the new picture frame and hang to fit into the two molded pins of the aquarium tank and lightly push the frame bottom to be fastened with buckles.

### 3.3 Change background picture

3.3.1 Turn off the power switch, open the top cover and unplug for the lighting.

3.3.2 Remove the flow diverter and the filter.

3.3.3 Manually pull out six plastic stoppers.

3.3.4 Slide new background picture behind back of existing background picture.

3.3.5 Once secure, remove old background picture.

3.3.6 Replace six plastic stoppers.

3.3.7 Plug for the lighting and turn off the power switch.

3.3.8 Readjust the time setting.

## Product Specifications



Model	Aquarium 500R
Voltage	220V~240V/50Hz or 110V/60Hz
Temperature Scope	6°C - 32°C / 42.8°F - 89.6°F
Time Control	24 Hours
Use Condition	Indoors
Dimension	24"(L) × 24"(W) × 4.2"(D) 610mm(L) × 610mm(W) × 110mm(D)
Display Window	20"(L) × 20"(W) 500mm(L) × 500mm(W)
Weight	29lbs(13kg) in packaging 80lbs(36kg) with water
Tank Material	High impact strength ABS resin
Tank Forming	Plastic injection molding
Tank Capacity	6.6us gallon 5.5uk gallon 25 liter

**AquaVista Enterprise, Inc**

3723 Haven Avenue  
Menlo Park, CA 94025  
Toll Free (888) 627-8284  
Phone: (408) 453-4151  
Fax: (650) 240-3955

[info@AquaVistainc.com](mailto:info@AquaVistainc.com)  
[www.AquaVistainc.com](http://www.AquaVistainc.com)